



The Resilient Communities Project:

The Resilient Communities Project is a response to pressing community identified issues with all aspects of sustainability. After a competitive request-for proposal process, the community of **North Saint Paul was chosen to partner with RCP.** Our development will target the need for **Live/Work housing in NSP and will strive to achieve the following goals:**

- Create a viable live/work/shop/play concept for mixed income residents
- Preserve the authentic character of downtown North Saint Paul
- Achieve community support and further local economic development

Proposed Site: Northeast Corridor



- Close proximity to the downtown strip
- Three buildings to enhance the neighborhood culture
- Live/work development is in line with the Master Redevelopment Plan in this area of North Saint Paul

Local Ammenities of NSP:

- Vibrant downtown with antique stores and a professional interior design service that can utilize resident's artwork and other creations
- Local cultural events for residents to enjoy
- Gateway Bike Path and many nearby parks



Brick and stucco facade to compliment local architecture (Left), Second Floor Loft style interiors to maximize space (Top Middle), a hat maker and pottery artist at work (Below Middle and Right)



The annual car show in front of the Antique Mall (Top), below, the Gateway Bike Trail (Left) & a restaurant downtown. (Right)

Embracing Live/Work:



Each storefront will begin as empty (Left) and will be topped by a one bedroom unit for store owners.

The Third Floor:

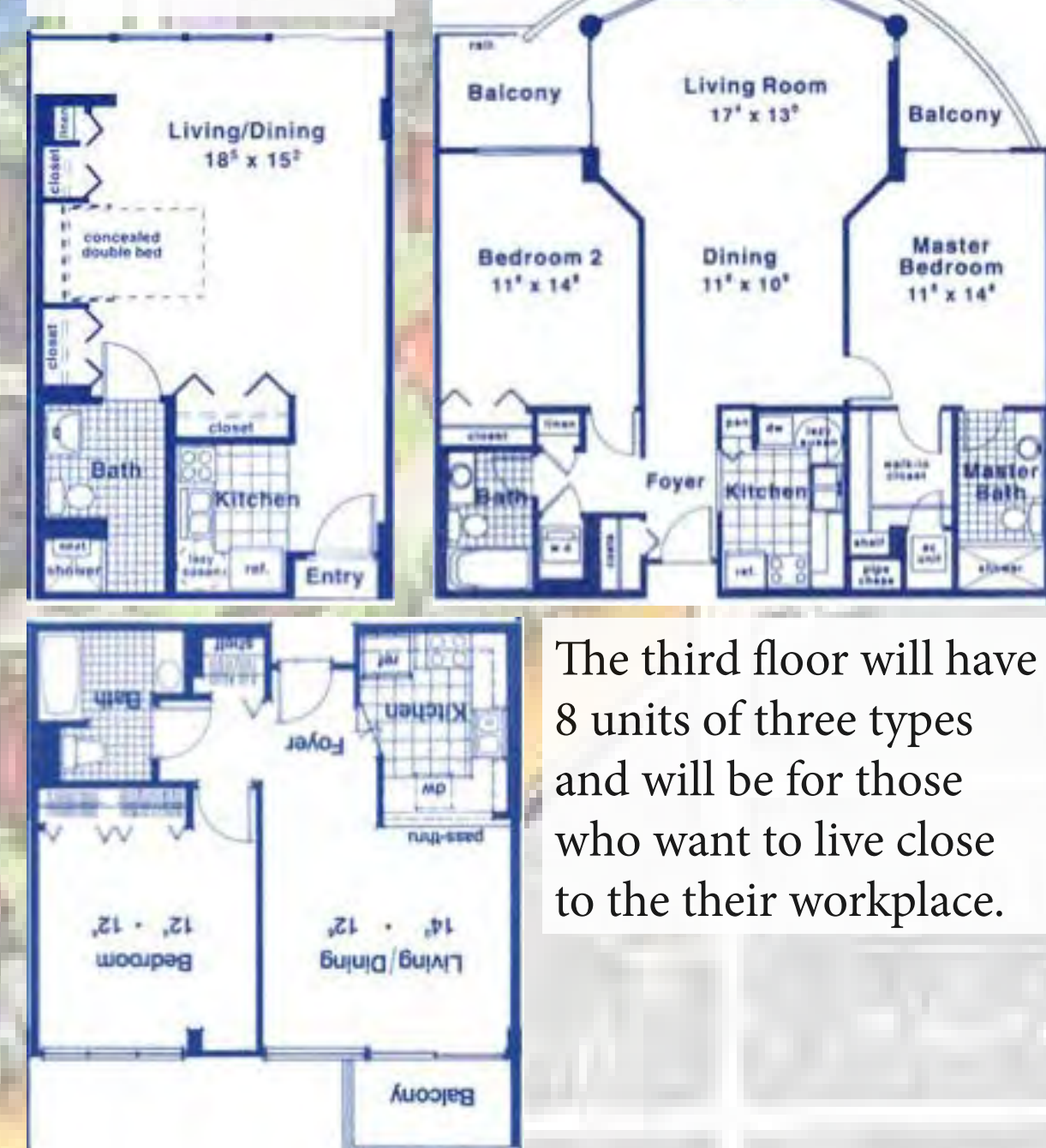

The third floor will have 8 units of three types and will be for those who want to live close to their workplace.

Sustainable Living:

- Superior area walkability and access to public transportation
- Building materials with low to no VOC's and FSC certified lumber**
- Rooftop gardens that will reduce food costs and solar heat gain
- Secured bicycle storage with maintenance services



Secured bike storage (Left) and one of the three co-op rooftop gardens for residents to use (Right)



Poster Credits:

- Class: HSG4461: Dr. Becky Yust and Dr. Marilyn Bruin
- Students: Vuthy Taing, Callway McCormick and Pierce Conway
- Poster created by Pierce William Conway

This Project was completed as part of HSG 4461, Housing Development and Management, a course at the University of Minnesota, with support from the Resilient Communities Project (RCP). RCP is an initiative of the Sustainability Faculty Network at the University of Minnesota, with funding and administrative support provided by the Center for Urban and Regional Affairs (CURA) and the Institute on the Environment (IonE).